

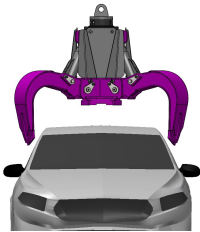

# Vulture AutoGrab

## Specialist “End of Life” Vehicle Dismantling and Handling Grab



Offset design of the grab legs allows the grab to clear the width of the vehicle.

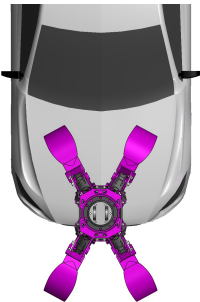

Offset design of the grab legs allows the grab fit within the vehicle chassis for pulling engines out

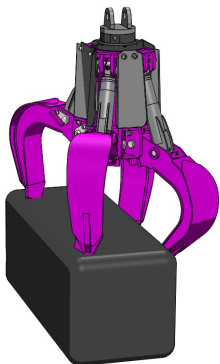

Offset design of the grab legs allows the grab lift baled vehicles in a manner that always keeps one side of the bale clear for easy stacking and loading.



Manufactured in the UK from a mix of high yield and wear resistant specialist steels which give the Vulture Autograb strength, flexibility and durability where needed.

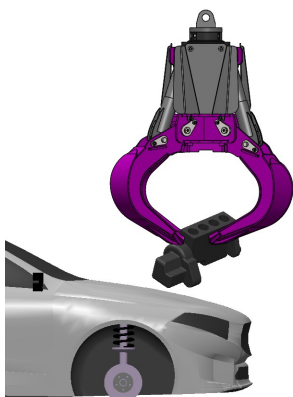

Well guarded hydraulic cylinders produce excessive gripping forces which are ideal for engine removal.

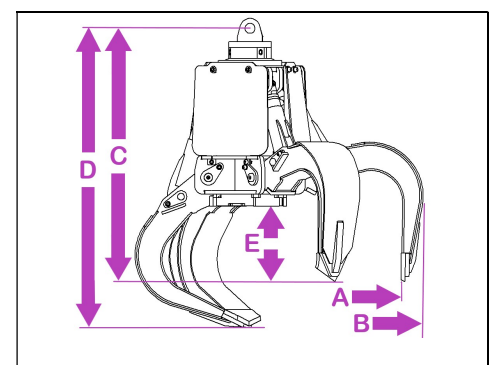

A. 1810mm	B. 2075mm
C. 1500mm	D. 1770mm
E. 450mm	Weight. 1150Kg

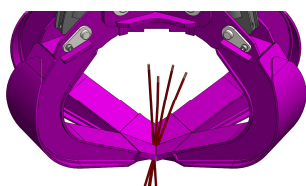

Fully closed leg tips allow for precision removal of vehicle wiring looms

Vulture Recycling Equipment (Euroroute Ltd.)  
St.Mary's Ind. Est., Dumfries, Scotland, DG1 1NA.  
+44 (0)1387 272904